

■ WT200 Features

Independently driven top feed

- Equipped with the independently driven top and bottom feed mechanism, larger differential feed ratios can be obtained.
- ※ A ruffling operation can be performed on stretchable fabrics.

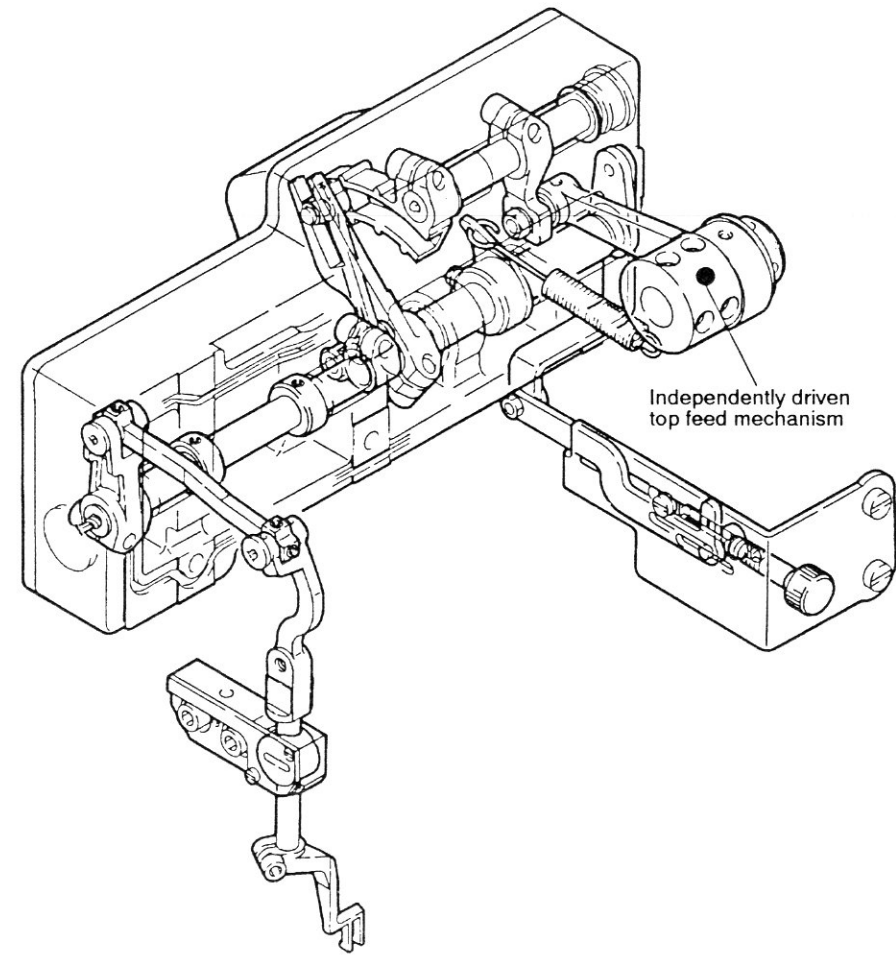
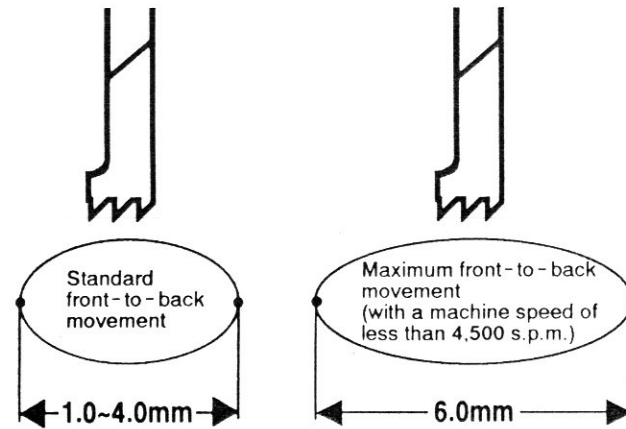

■ WT200 Features

Easy-to-remove presser foot

- Remove the presser foot by loosening the presser foot set screw and raising the presser foot (lowering the foot lift lever). The top feed dog is simultaneously raised, so removing the presser foot is easy.

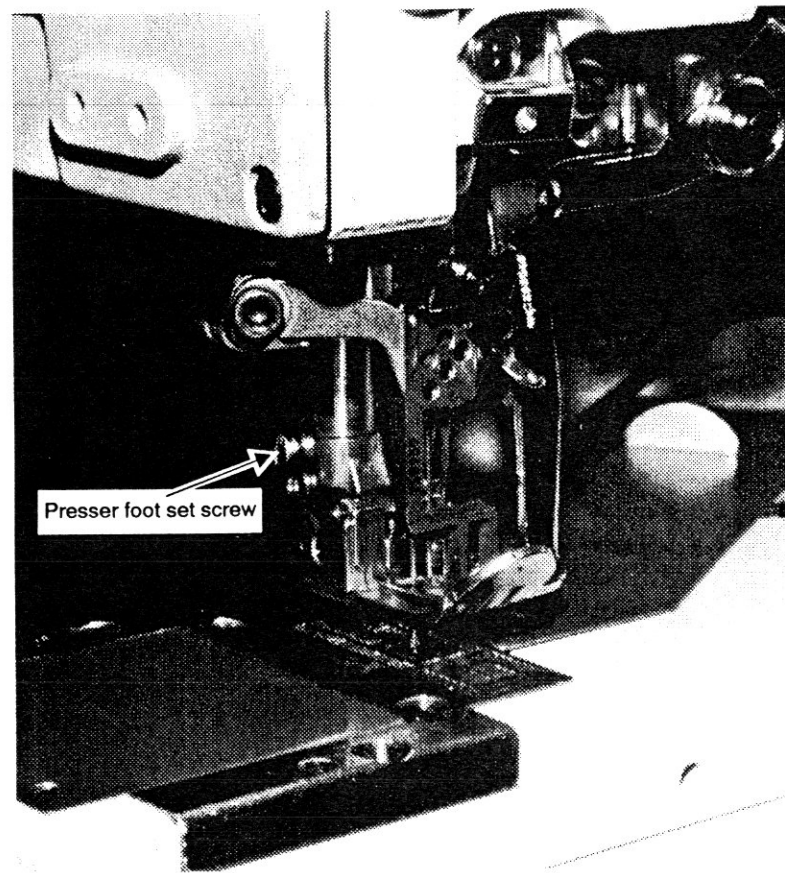

Top feed dog teeth with diamond cut

- Diamond cut (used on the EXT Series) that increases feed efficiency is adopted on the top feed dog of the WT200 Series. (The bottom feed dogs use conventional parallel feed dog teeth.)

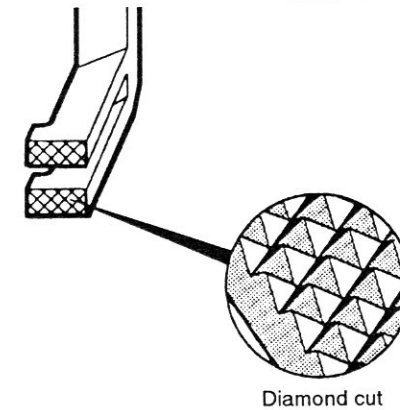

W(T)200 Subclass specifications

WT 264 - 01C B × 2 40

1
2
3
4

1 Subclass

3 No. of needles

2 Needle plate type

4 Needle space (mm)

A : The machine produces seams with tightened needle thread.
Suitable for fine stitch length (less than 1.7mm).

B : Standard stitch (1.8 - 2.3mm)

C : The machine produces seams with affluent needle thread.
Suitable for coarse stitch length (more than 2.5mm).

W200 Series subclasses

| Application | Subclass | No. of needles | No. of threads | Needle space (mm) | Stitch length (mm) | Differential feed ratio | Foot lift (mm) | Machine speed (s.p.m.) | Remarks |
|---------------|-----------|----------------|----------------|-------------------|--------------------|-------------------------|----------------|------------------------|--|
| Plain seaming | W264-01CB | 2 | 4 | 3.2•4•4.8•5.6•6.4 | 0.9~4.2 | 0.8~1.8 | 5.8 | 5,000 | |
| | -01CC | 3 | 5 | 5.6•6.4 | | | 5.1 | | |
| | W264-01EB | 2 | 4 | 4.8 | 0.9~4.2 | 0.8~1.8 | 5.8 | 5,000 | |
| | | 3 | 5 | 5.6•6.4 | | | 5.1 | | |
| Covering | W264-03FB | 2 | 4 | 4•4.8•5.6•6.4 | 0.9~4.2 | 0.8~1.8 | 5.8 | 5,000 | Flattening out overlock seams (for medium to heavy weight fabrics) |
| | -03FC | 3 | 5 | 5.6•6.4 | | | 5.1 | | |
| | W264-03GB | 2 | 4 | 4•4.8 | 0.9~4.2 | 0.8~1.8 | 5.8 | 5,000 | Folding over overlock seams (for light weight fabrics) |
| | -03GC | 3 | 5 | 5.6•6.4 | | | 5.1 | | |
| Hemming | W264-08AB | 2 | 4 | 4•4.8 | 0.9~4.2 | 0.8~1.8 | 5.8 | 5,000 | Hem width : narrow |
| | -08AC | 3 | 5 | 5.6•6.4 | | | 5.1 | | |
| | W264-08BB | 2 | 4 | 3.2•4•4.8 | 0.9~4.2 | 0.8~1.8 | 5.8 | 5,000 | Hem width : wide |
| | 3 | 5 | 5.6•6.4 | 5.1 | | | | | |
| | W264-08BC | 2 | 4 | 4•4.8 | 0.9~4.2 | 0.8~1.8 | 5.8 | 5,000 | Hem width : wide |
| | | 3 | 5 | 5.6•6.4 | | | 5.1 | | |

Note: Max. machine speed varies according to differential feed ratio.
Max.differential feed ratio varies according to stitch length.

WT200 Series subclasses

| Application | Subclass | No. of needles | No. of threads | Needle space (mm) | Stitch length (mm) | Differential feed ratio | Top feed dog front-to-back movement amount (mm) | Foot lift (mm) | Machine speed (s.p.m.) | Remarks |
|---------------|------------|----------------|----------------|-------------------|--------------------|-------------------------|---|----------------|------------------------|--|
| Plain seaming | WT264-01CB | 2 | 4 | 3.2•4•4.8•5.6•6.4 | 0.9~4.2 | 0.8~1.8 | 1~6 | 6 | 5,000 | |
| | -01CC | 3 | 5 | 5.6•6.4 | | | | | | |
| | WT264-01EB | 2 | 4 | 4.8 | 0.9~4.2 | 0.8~1.8 | 1~6 | 6 | 5,000 | |
| | | 3 | 5 | 5.6•6.4 | | | | | | |
| Covering | WT264-03FB | 2 | 4 | 4•4.8•5.6•6.4 | 0.9~4.2 | 0.8~1.8 | 1~6 | 6 | 5,000 | Flattening out overlock seams (for medium to heavy weight fabrics) |
| | -03FC | 3 | 5 | 5.6•6.4 | | | | | | |
| | WT264-03GB | 2 | 4 | 4•4.8 | 0.9~4.2 | 0.8~1.8 | 1~6 | 6 | 5,000 | Folding over overlock seams (for light weight fabrics) |
| | -03GC | 3 | 5 | 5.6•6.4 | | | | | | |
| Hemming | WT264-08AB | 2 | 4 | 4•4.8 | 0.9~4.2 | 0.8~1.8 | 1~6 | 6 | 5,000 | Hem width : narrow |
| | -08AC | 3 | 5 | 5.6•6.4 | | | | | | |
| | WT264-08BB | 2 | 4 | 3.2•4•4.8 | 0.9~4.2 | 0.8~1.8 | 1~6 | 6 | 5,000 | Hem width : wide |
| | | 3 | 5 | 5.6•6.4 | | | | | | |
| | WT264-08BC | 2 | 4 | 4•4.8 | 0.9~4.2 | 0.8~1.8 | 1~6 | 6 | 5,000 | Hem width : wide |
| | | 3 | 5 | 5.6•6.4 | | | | | | |

Note: Max. machine speed varies according to differential feed ratio and top feed dog movement amount.
Max.differential feed ratio varies according to stitch length.

■ W(T)200/UT Application list

Electric UT specifications

| Type | Operational method | Remarks | | |
|-------|--------------------------------|------------------------|-------------------|--------------------------|
| | | Top cover thread wiper | Presser foot lift | Top cover thread trimmer |
| UT117 | Pressing the treadle with heel | Electric | Electric | — |
| UT118 | " | Electric | — | — |
| UT119 | " | — | Electric | — |
| UT120 | " | — | — | — |
| UT216 | " | — | Electric | Electric |
| UT217 | " | — | — | Electric |

Electric UT application

| Type | Subclass | | | | | |
|-------|--------------|--------------|--------------|---------------|---------------|---------------|
| | W264 - 01 | W264 - 03 | W264 - 08 | WT264 - 01 | WT264 - 03 | WT264 - 08 |
| UT117 | | | ○ | | | ○ |
| UT118 | | | ○ | | | ○ |
| UT119 | ○ | ○ | | ○ | ○ | |
| UT120 | ○ | ○ | | ○ | ○ | |
| UT216 | ○ | ○ | ○ | | | |
| UT217 | ○ | ○ | ○ | | | |

Note) Electric UT is unavailable with MS device.

Pneumatic UT specifications

| Type | Operational method | Remarks | | |
|-------|--------------------------------|------------------------|-------------------|--------------------------|
| | | Top cover thread wiper | Presser foot lift | Top cover thread trimmer |
| UT322 | Pressing the treadle with heel | Electric | Pneumatic | — |
| UT323 | " | Electric | — | — |
| UT324 | " | — | Pneumatic | — |
| UT325 | " | — | — | — |
| UT326 | " | Pneumatic | Pneumatic | — |
| UT327 | " | Pneumatic | Pneumatic | — |
| UT450 | " | — | Pneumatic | Pneumatic |
| UT451 | " | — | — | Pneumatic |
| UT452 | " | — | Pneumatic | Pneumatic |
| UT453 | " | — | — | Pneumatic |

Pneumatic UT application

| Type | Subclass | | | | | |
|-------|--------------|--------------|--------------|---------------|---------------|---------------|
| | W264 - 01 | W264 - 03 | W264 - 08 | WT264 - 01 | WT264 - 03 | WT264 - 08 |
| UT322 | | | ○ | | | ○ |
| UT323 | | | ○ | | | ○ |
| UT324 | ○ | ○ | | ○ | ○ | |
| UT325 | ○ | ○ | | ○ | ○ | |
| UT326 | ○ | ○ | ○ | | | |
| UT327 | | | | ○ | ○ | ○ |
| UT450 | | | | ○ | ○ | ○ |
| UT451 | | | | ○ | ○ | ○ |
| UT452 | ○ | ○ | ○ | | | |
| UT453 | ○ | ○ | ○ | | | |

Note) Pneumatic UT are available with MS device.
MS device cannot be installed on subclasses with C type of needle plate finger.

■ W(T)200 Basic adjustments

Needle height

When the needle is at the top of its stroke, adjust distance (a) from the point of the left needle to the top surface of the needle plate (see Table 1). Follow the procedures below.

- (1) Turn handwheel ① until the needle bar is at the top of its stroke. Mark "P" on the handwheel should be aligned with alignment mark Δ .
- (2) Loosen screw ②. Adjust the needle height according to the needle space by moving needle bar ③ up or down.

Relationship between the needle space and the needle height

Table 1

| W200 Series | | | | WT200 Series | | | |
|-------------------|-----------------------------|-------------------|-----------------------------|-------------------|-----------------------------|-------------------|-----------------------------|
| 2-needle | | 3-needle | | 2-needle | | 3-needle | |
| Needle space (mm) | Left needle height (a) (mm) | Needle space (mm) | Left needle height (a) (mm) | Needle space (mm) | Left needle height (a) (mm) | Needle space (mm) | Left needle height (a) (mm) |
| 3.2 | 8.8 | — | — | 3.2 | 10.2 | — | — |
| 4.0 | 8.3 | — | — | 4.0 | 9.8 | — | — |
| 4.8 | 7.9 | — | — | 4.8 | 9.4 | — | — |
| 5.6 | 7.5 | 5.6 | 7.5 | 5.6 | 9.0 | 5.6 | 9.0 |
| 6.4 | 7.1 | 6.4 | 7.1 | 6.4 | 8.6 | 6.4 | 8.6 |

- After the above adjustment, check clearance (b) between needles and needle drop holes on the needle plate to make sure it is equal. Then tighten screw ②.

